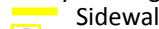
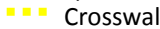







**Figure 4**  
One Quarter Mile Walk Shed

Likely walking route to/from transit stops:  
 Sidewalk  Crosswalk  
 Bus Stop  
 U Street Metrorail Station (Green & Yellow Lines)

 High Pedestrian Activity and Deficiency  
 Moderate Pedestrian Activity and Deficiency  
 Low Pedestrian Activity and Deficiency  
 Very Low Pedestrian Activity and Deficiency



**2300 16th Street NW**  
 Board of Zoning Adjustment  
 District of Columbia  
 CASE NO. 19689  
 EXHIBIT NO. 262





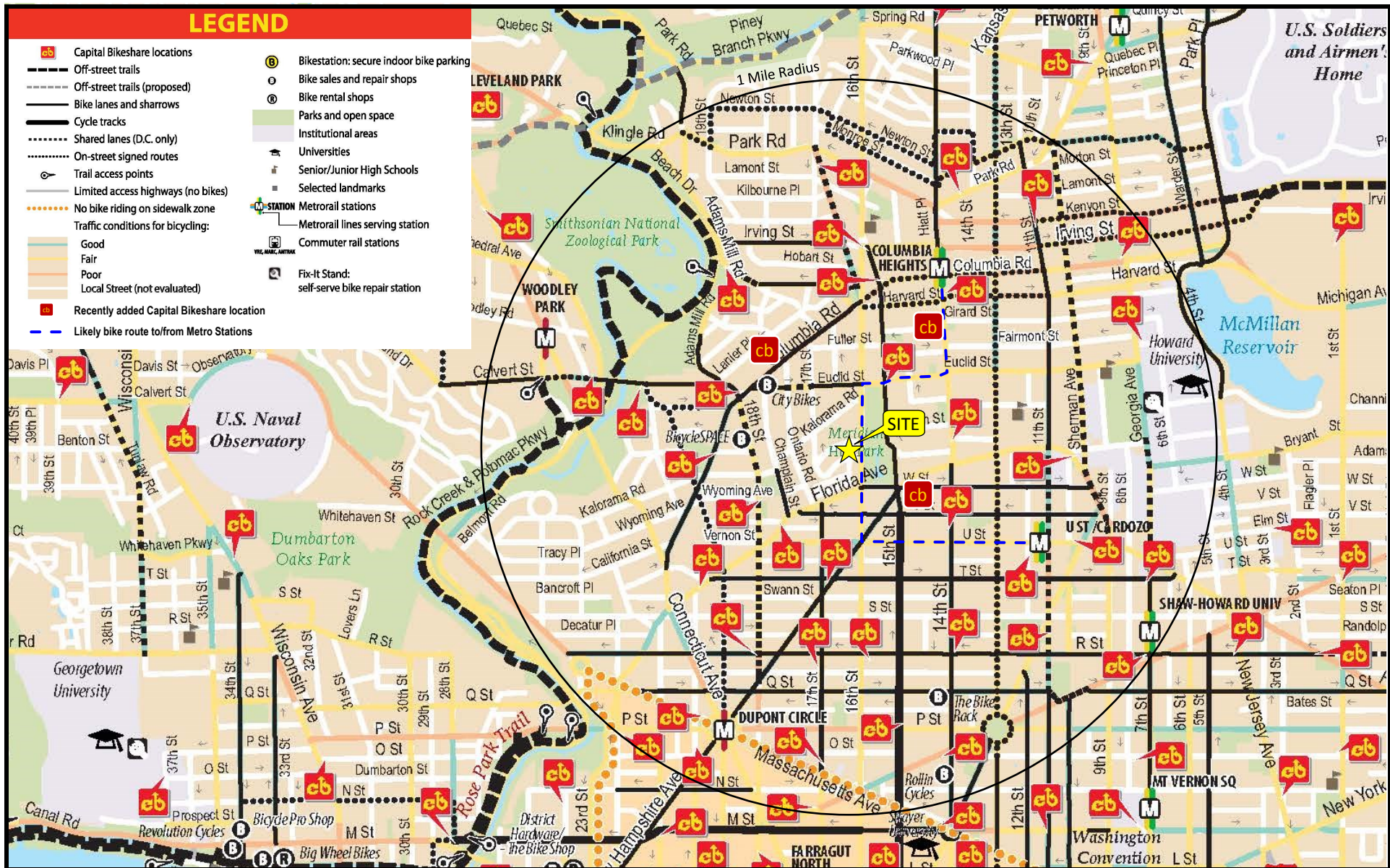

**Figure 5**  
One Mile Bike Shed



**NORTH**

**2300 16th Street NW  
Washington, DC**



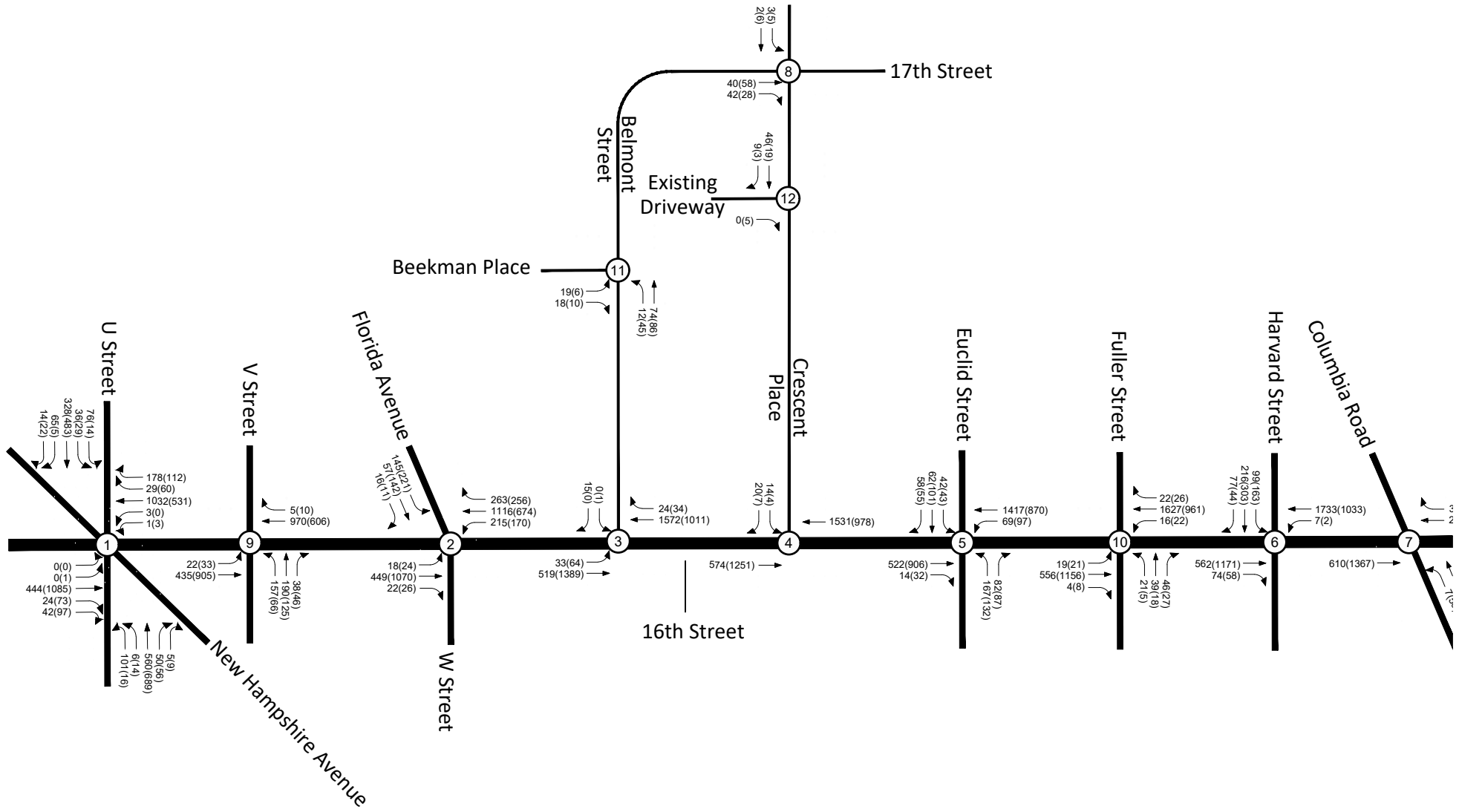

**Figure 6**  
Existing Peak Hour Traffic Volumes

AM PEAK HOUR  
PM PEAK HOUR



NORTH

2300 16th Street NW  
Washington, DC



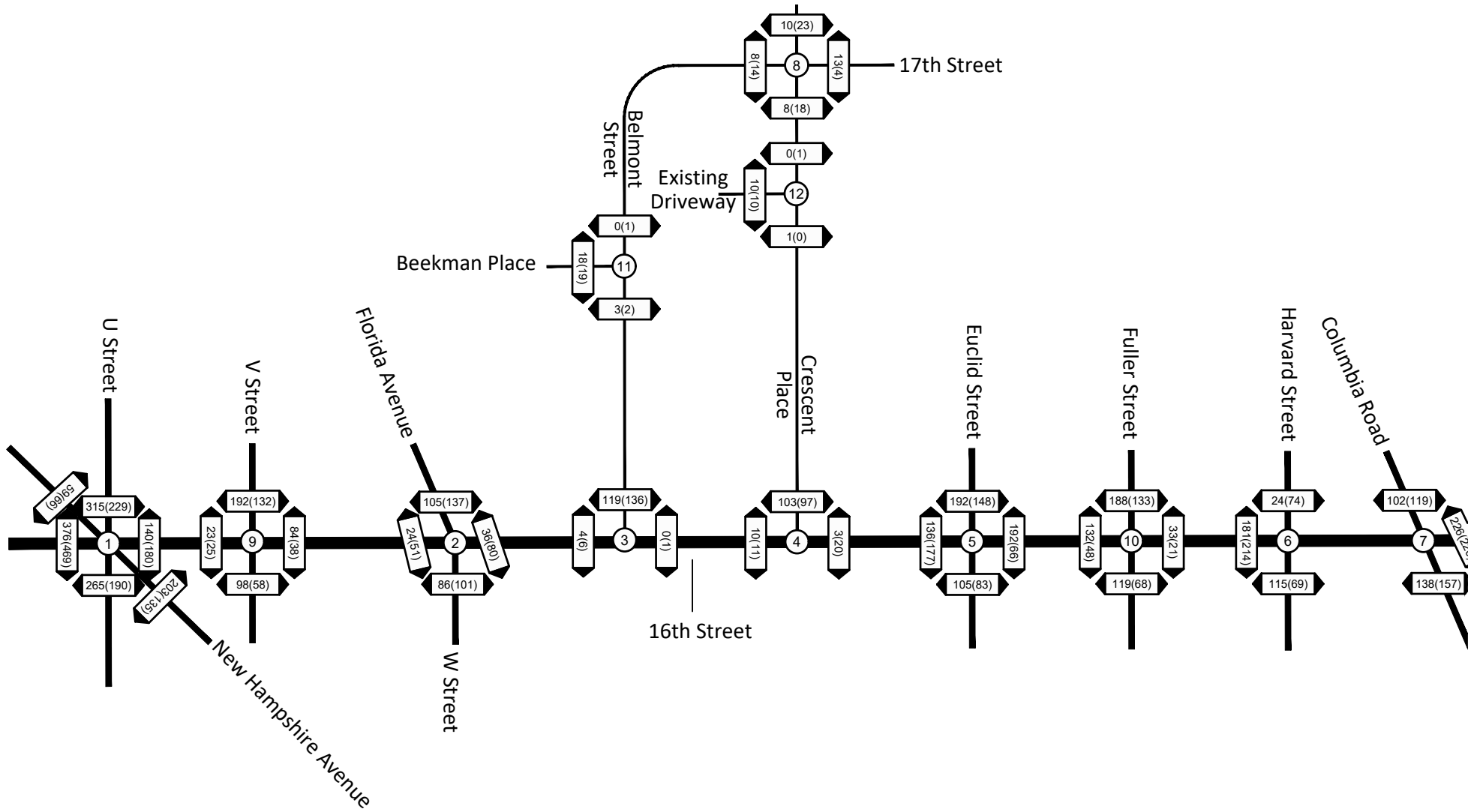

**Figure 7**  
Existing Peak Hour Pedestrian Volumes

AM PEAK HOUR  
PM PEAK HOUR



NORTH

2300 16th Street NW  
Washington, DC



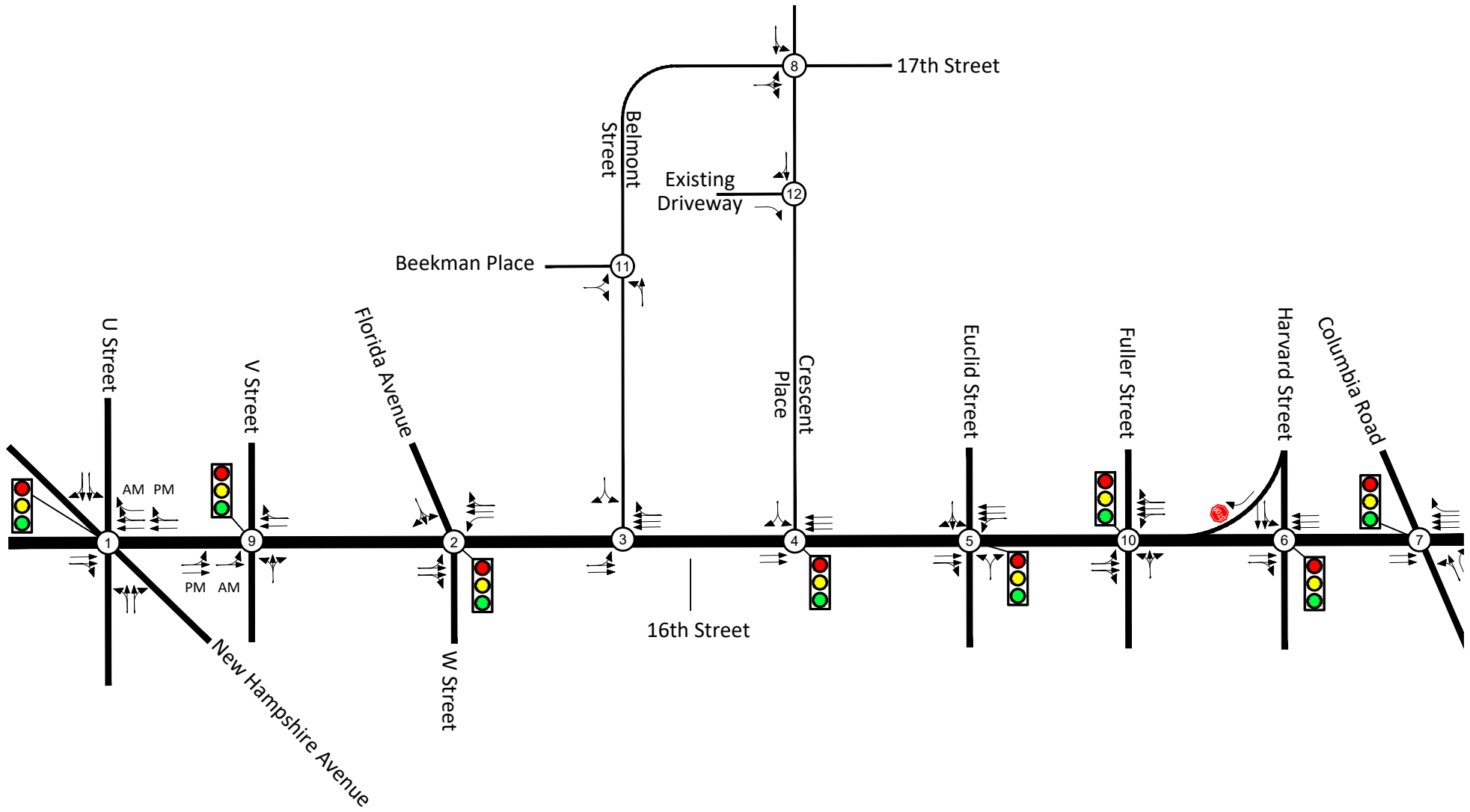

**Figure 8**  
Existing Lane Use and Traffic Control

- ← Represents One Travel Lane
- 🚦 Signalized Intersection
- 🛑 Stop Sign



NORTH  
2300 16th Street NW  
Washington, DC





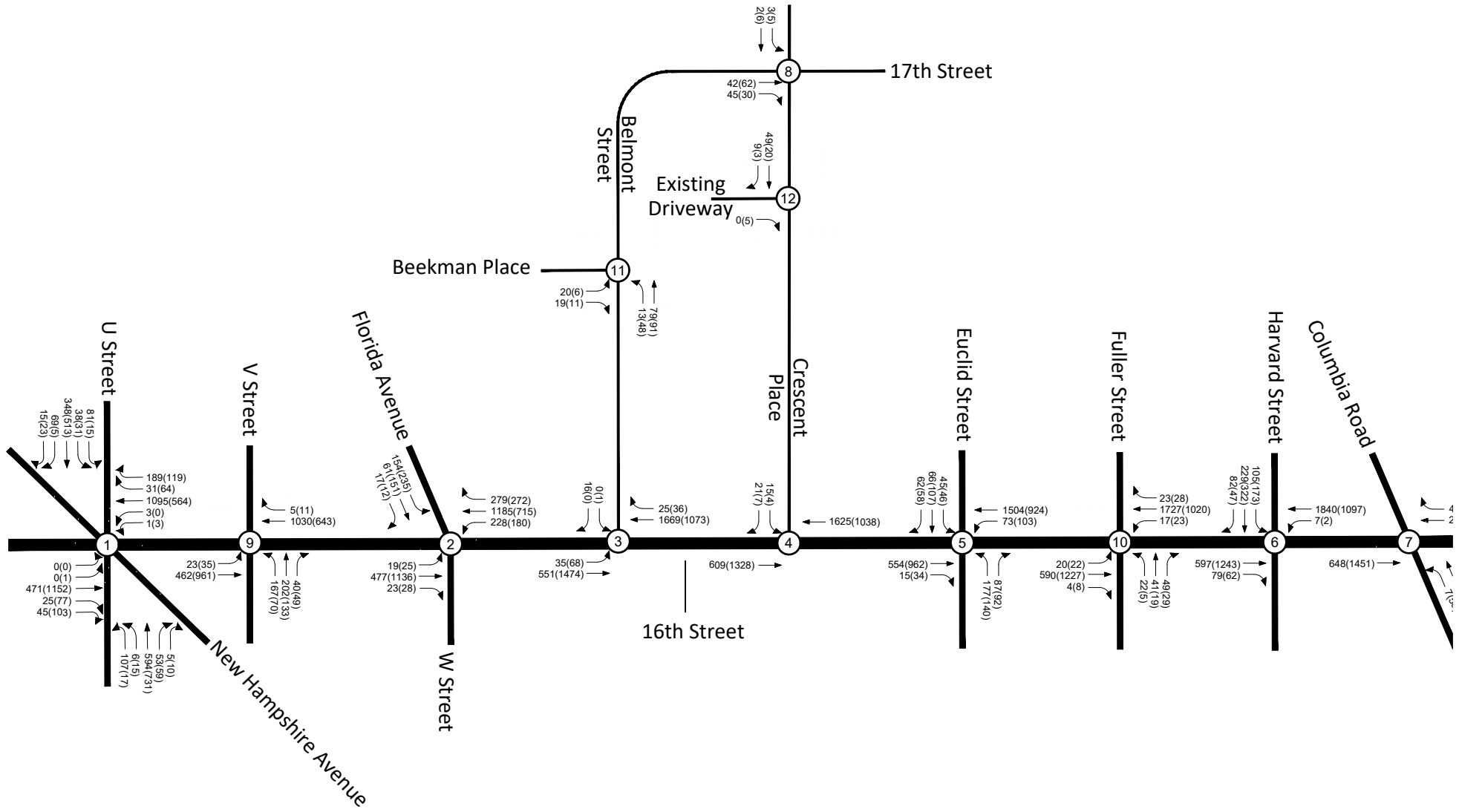

**Figure 9**  
Existing Peak Hour Traffic Volumes with Regional Growth

AM PEAK HOUR  
PM PEAK HOUR



NORTH

2300 16th Street NW  
Washington, DC





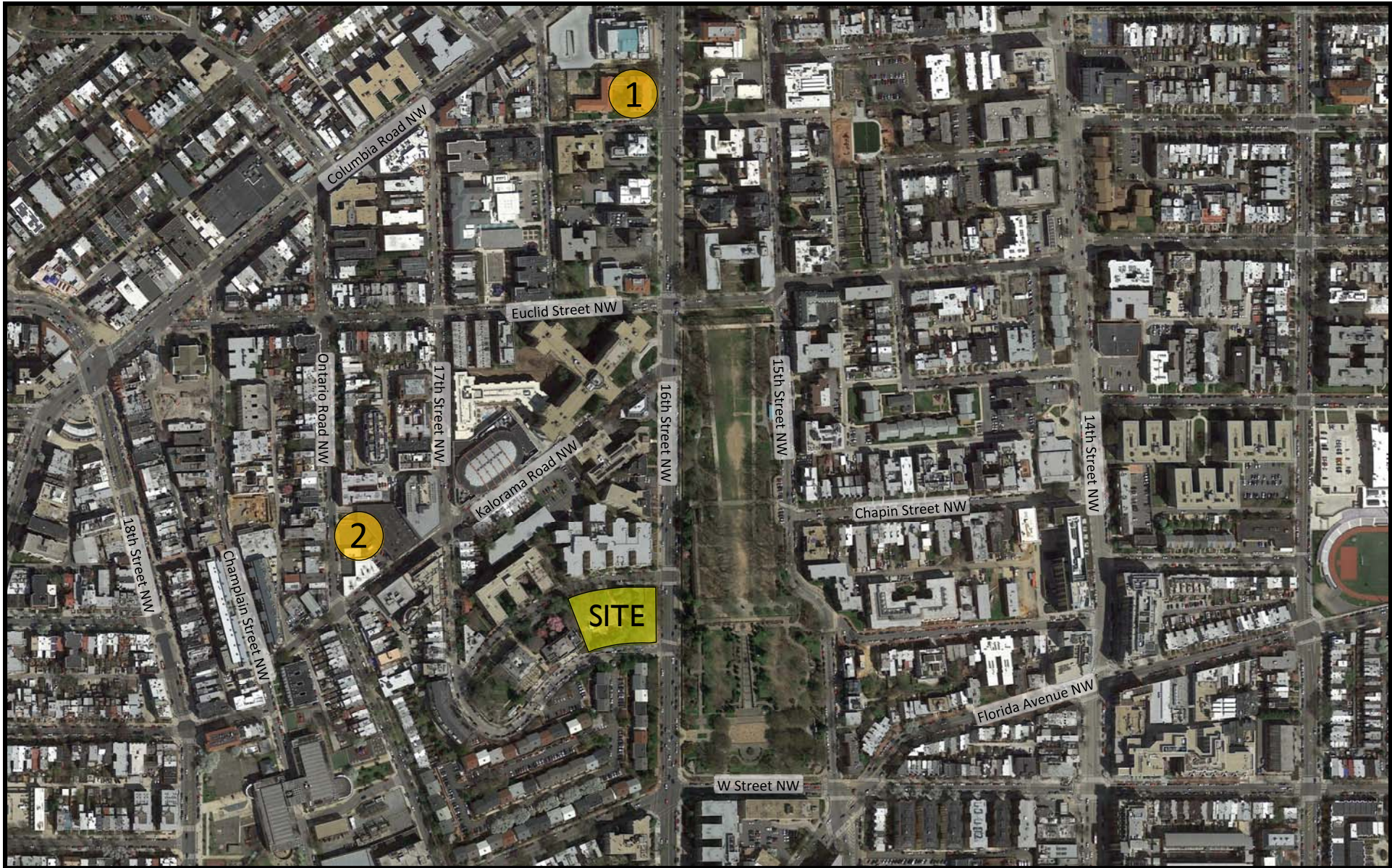

**Figure 10**  
Pipeline Locations

- ① Il Palazzo
- ② 2341 Ontario Road NW



**NORTH**

**2300 16th Street NW  
Washington, DC**





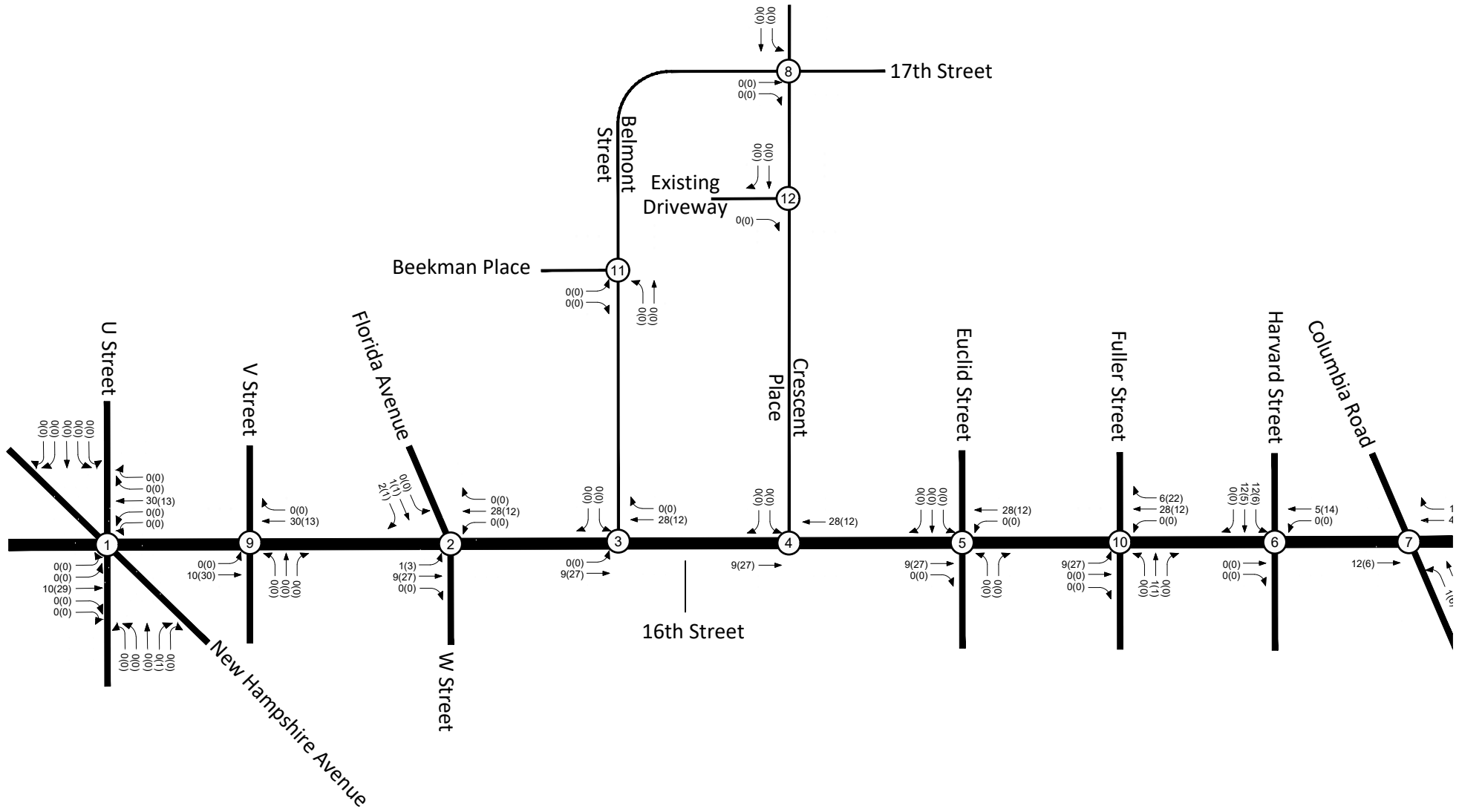

Figure 11  
Pipeline Traffic Volumes

AM PEAK HOUR  
PM PEAK HOUR



NORTH

2300 16th Street NW  
Washington, DC





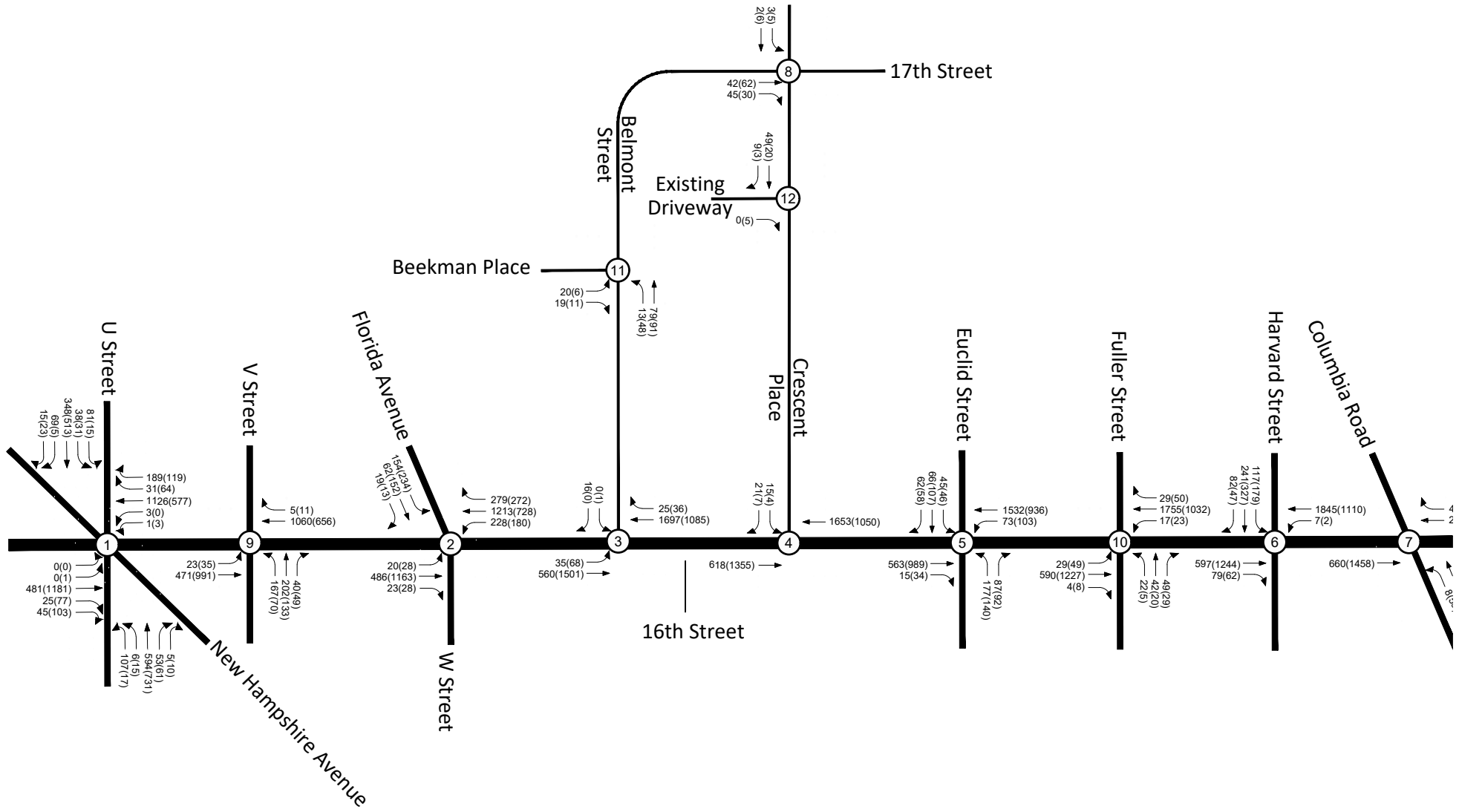

Figure 12  
2022 Background Peak Hour Traffic Volumes

AM PEAK HOUR  
PM PEAK HOUR  
000 (000)



NORTH

2300 16th Street NW  
Washington, DC



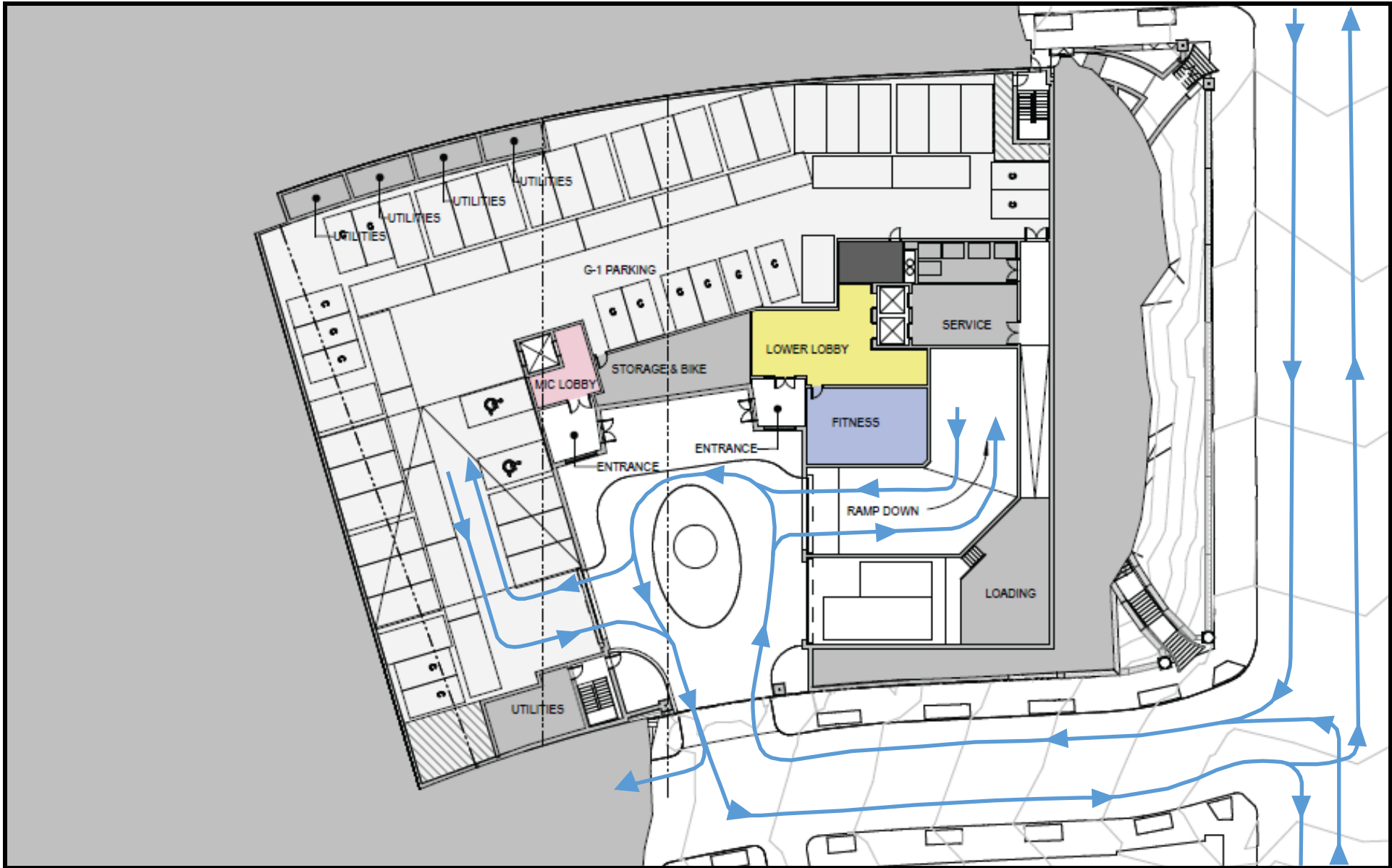

**Figure 13A**  
 Vehicular Circulation  
 Parking G1

→ Vehicle Circulation



**NORTH**



2300 16th Street NW  
 Washington, DC



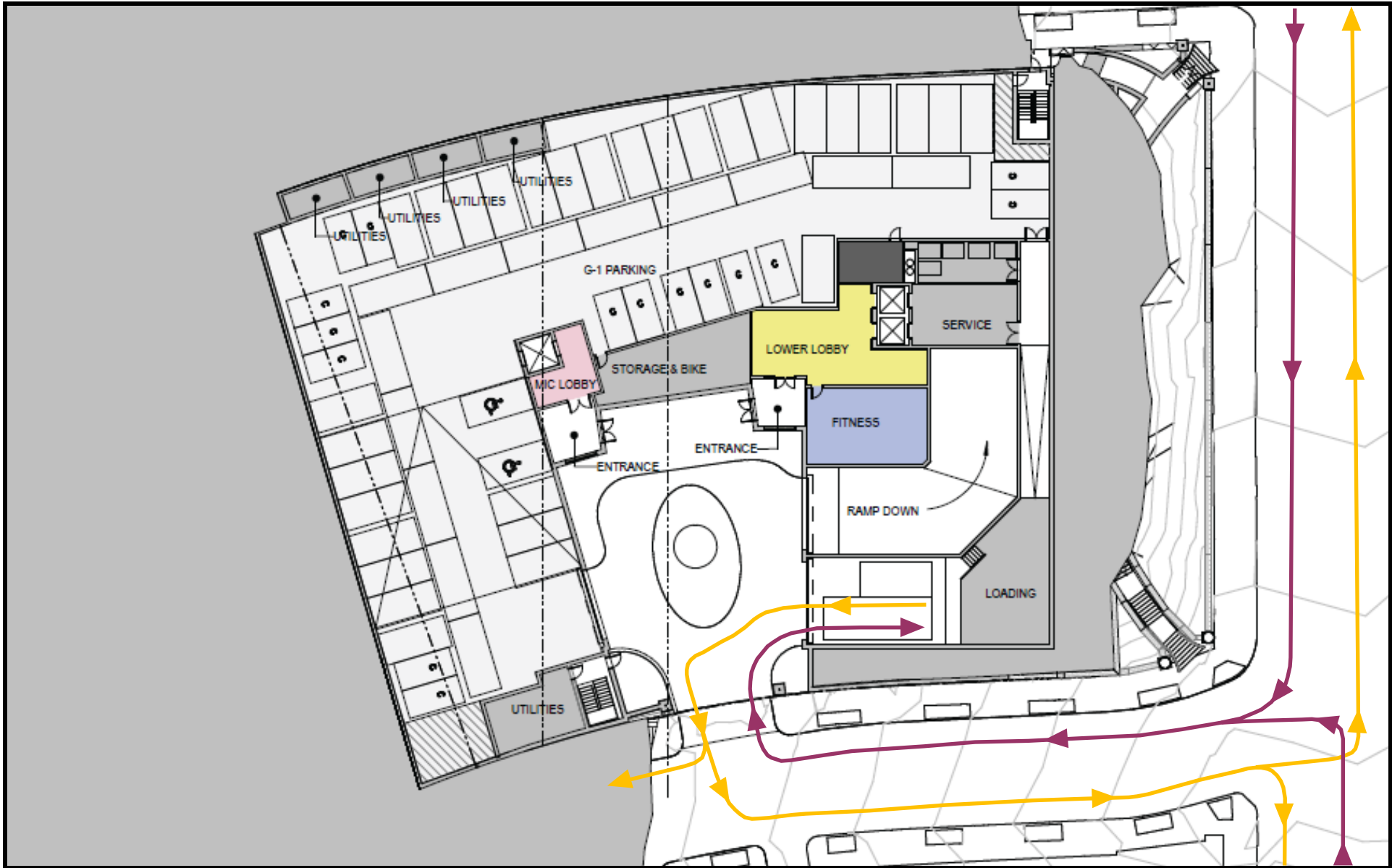



**Figure 13B**  
 Loading Access  
 Parking G1

 Inbound  
 Outbound



**NORTH**

2300 16th Street NW  
 Washington, DC



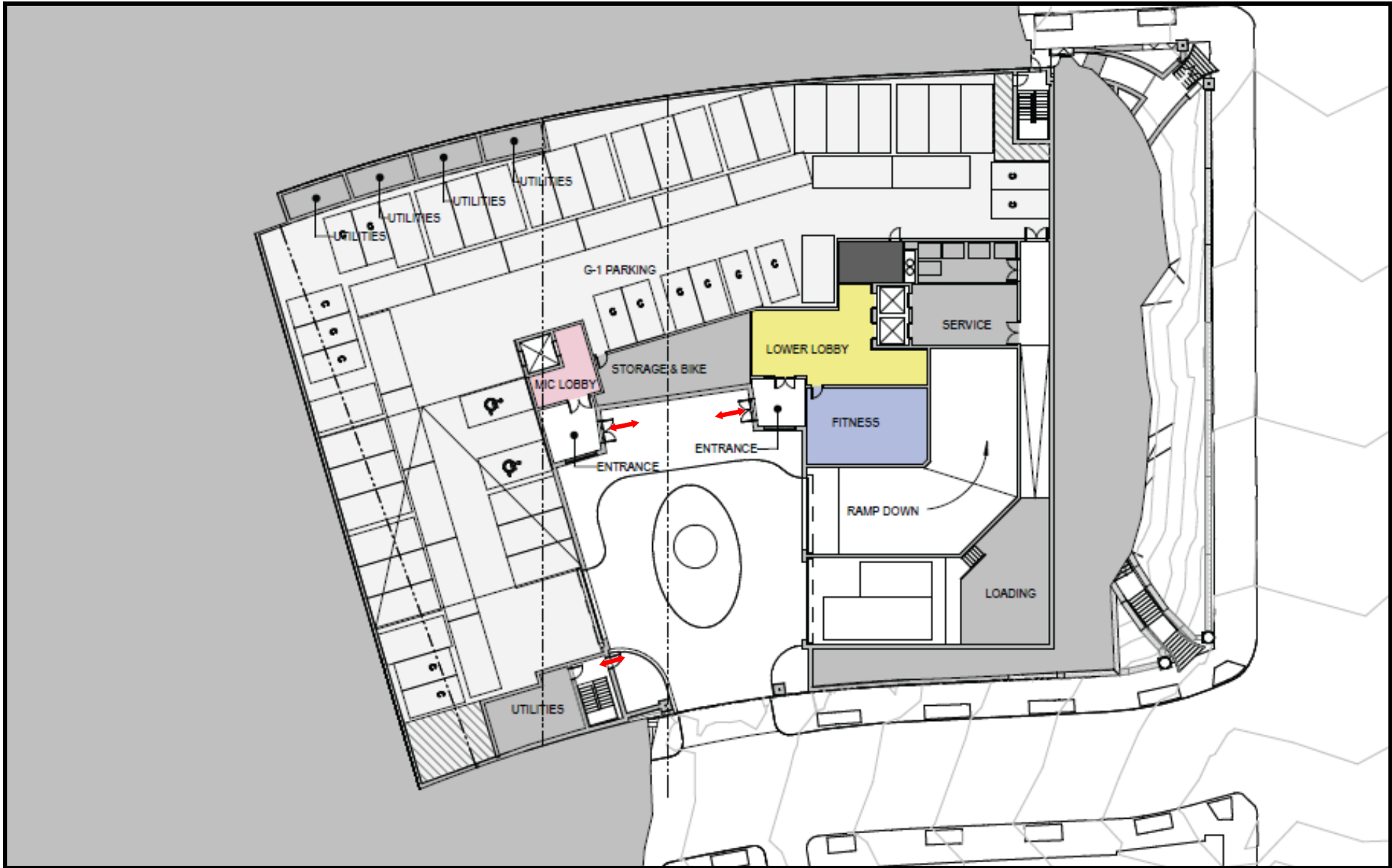

**Figure 13C**  
 Pedestrian Access  
 Level G1

↔ Pedestrian Access



**NORTH**

2300 16th Street NW  
 Washington, DC





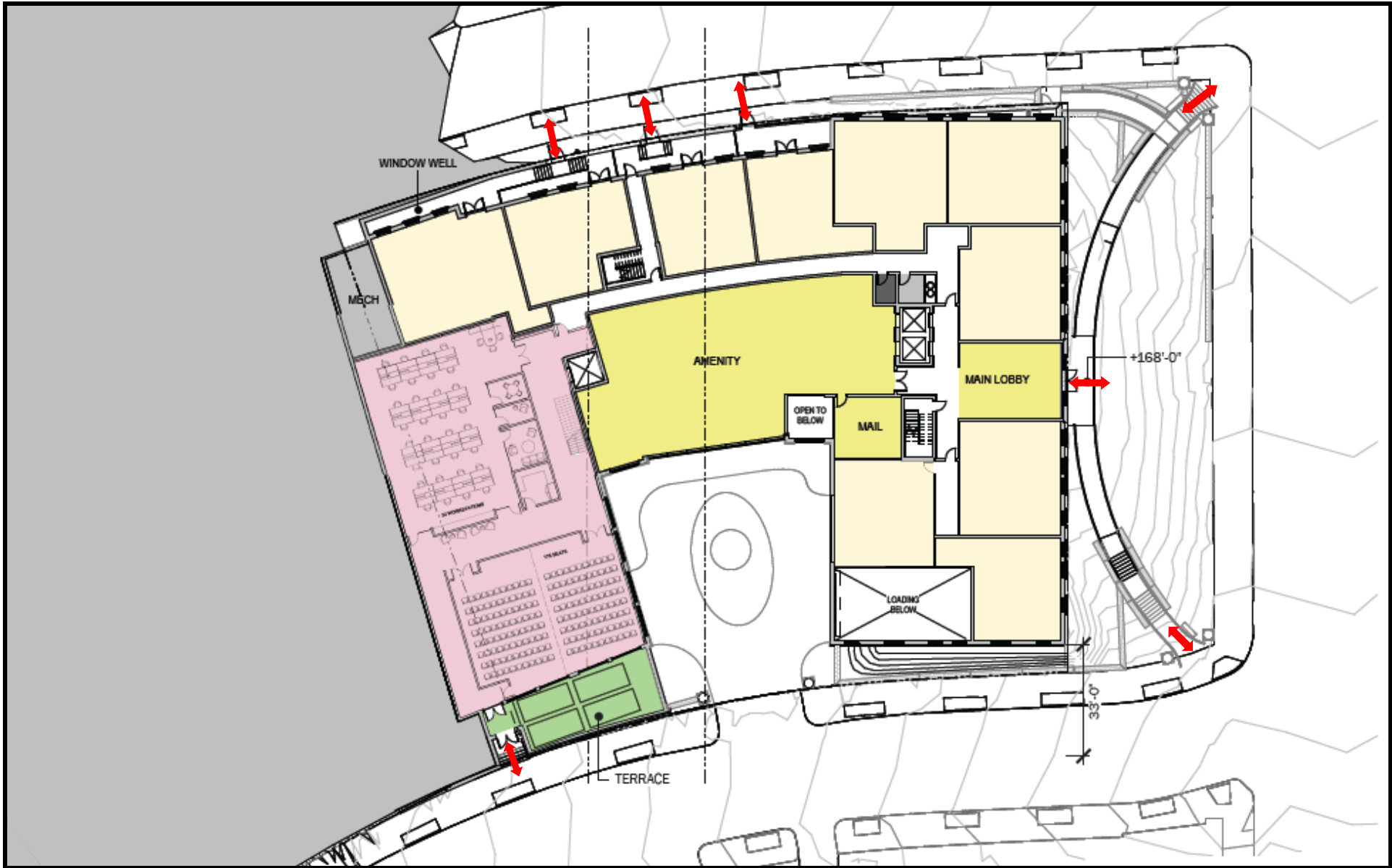

**Figure 13D**  
 Pedestrian Access  
 First Floor

↔ Pedestrian Access



NORTH

2300 16th Street NW  
 Washington, DC



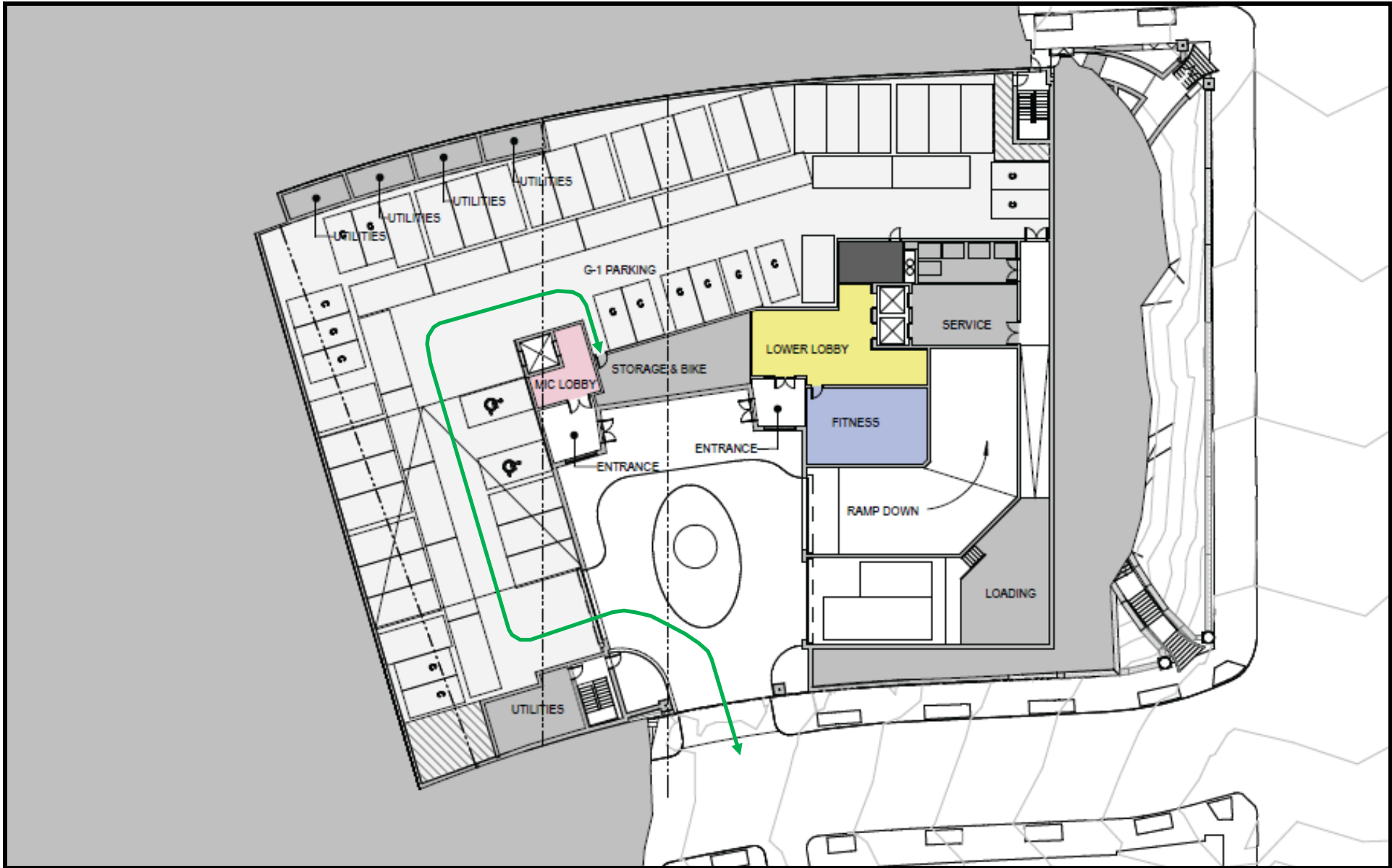

**Figure 13E**  
 Bike Circulation  
 Parking G1

↔ Bicycle Access



**NORTH**

2300 16th Street NW  
 Washington, DC





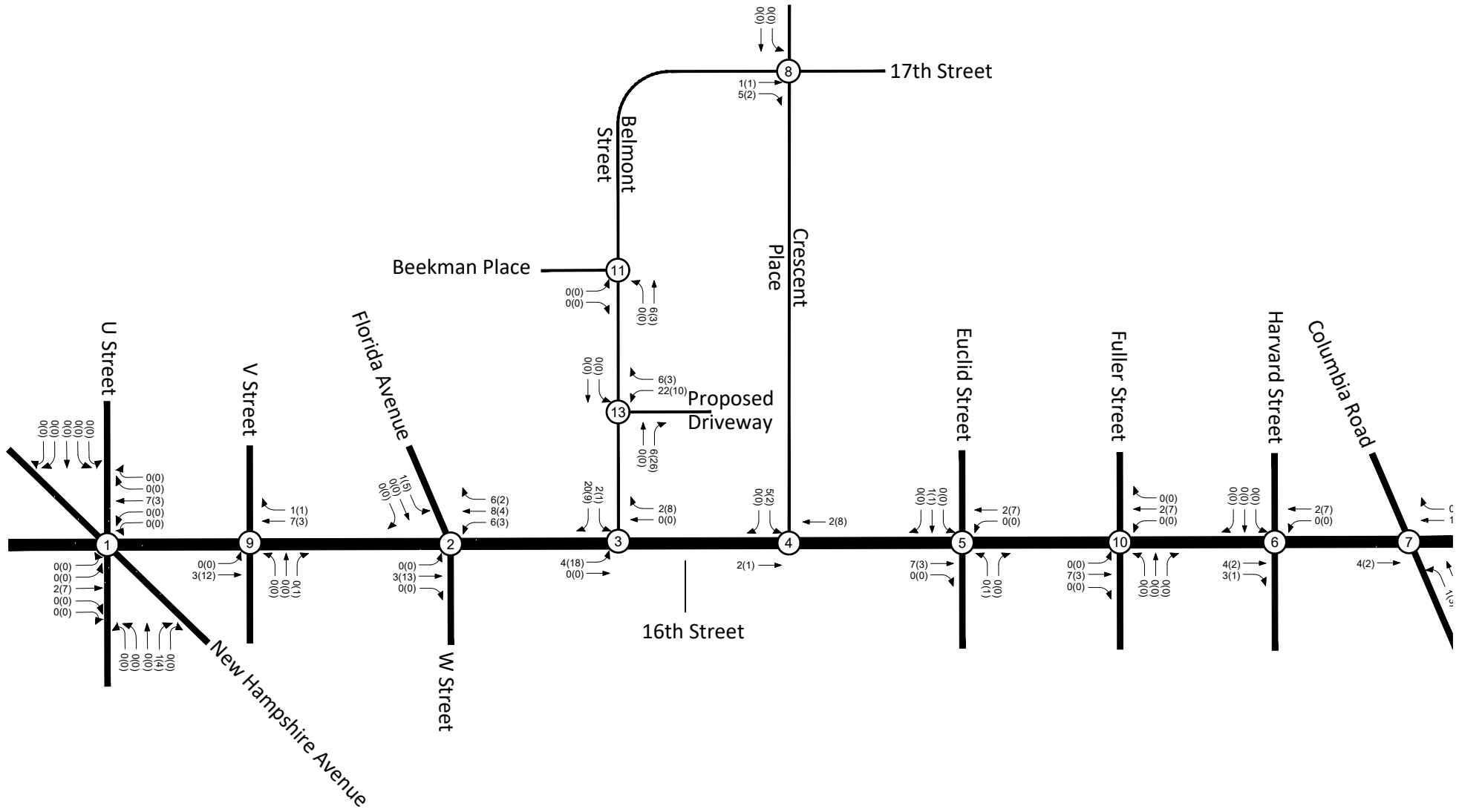

Figure 14  
Site Trips

AM PEAK HOUR  
PM PEAK HOUR



NORTH

2300 16th Street NW  
Washington, DC



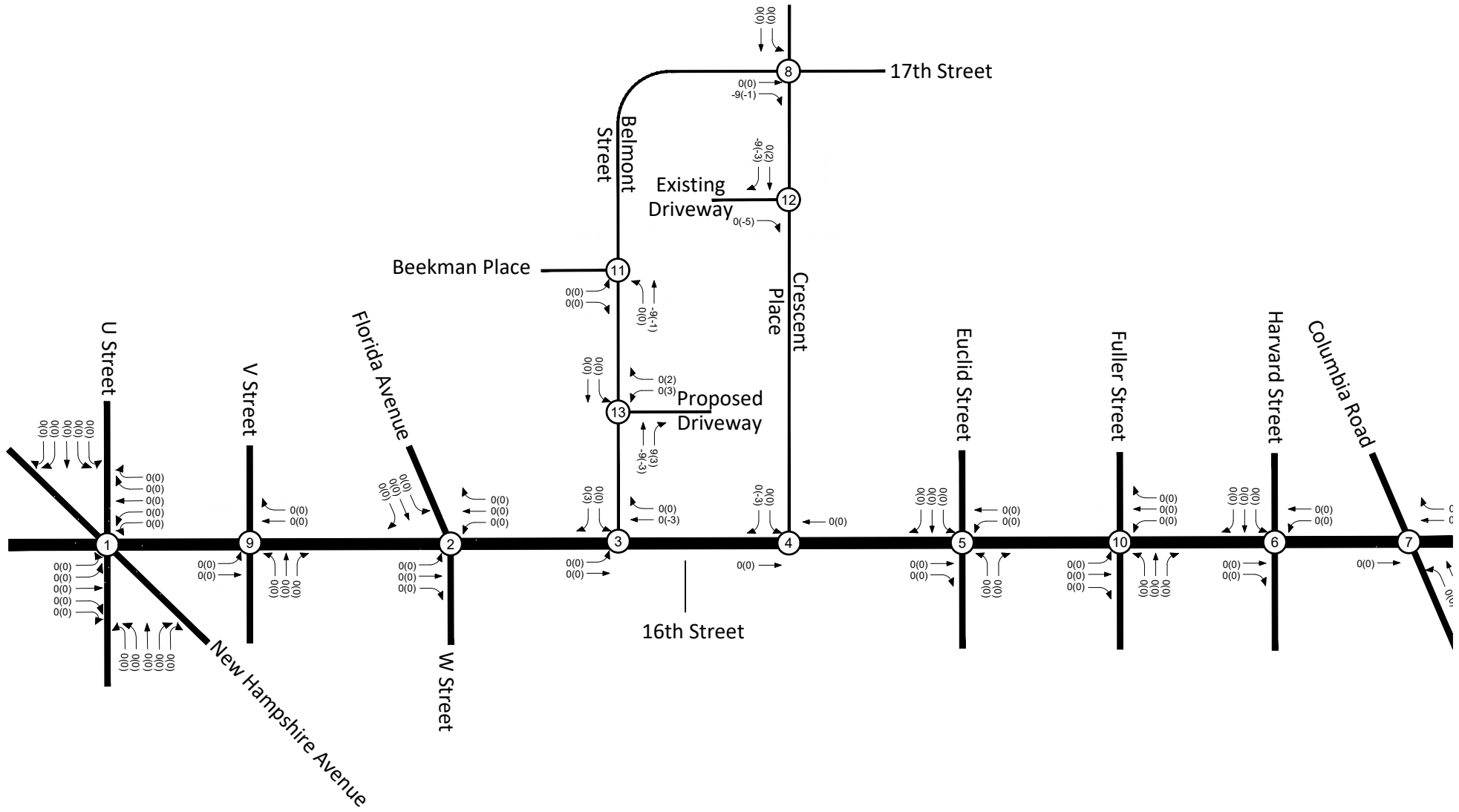

Figure 15A  
Rerouted Trips Due to Closure of Existing Driveway

AM PEAK HOUR  
PM PEAK HOUR  
000 (000)



NORTH

2300 16th Street NW  
Washington, DC





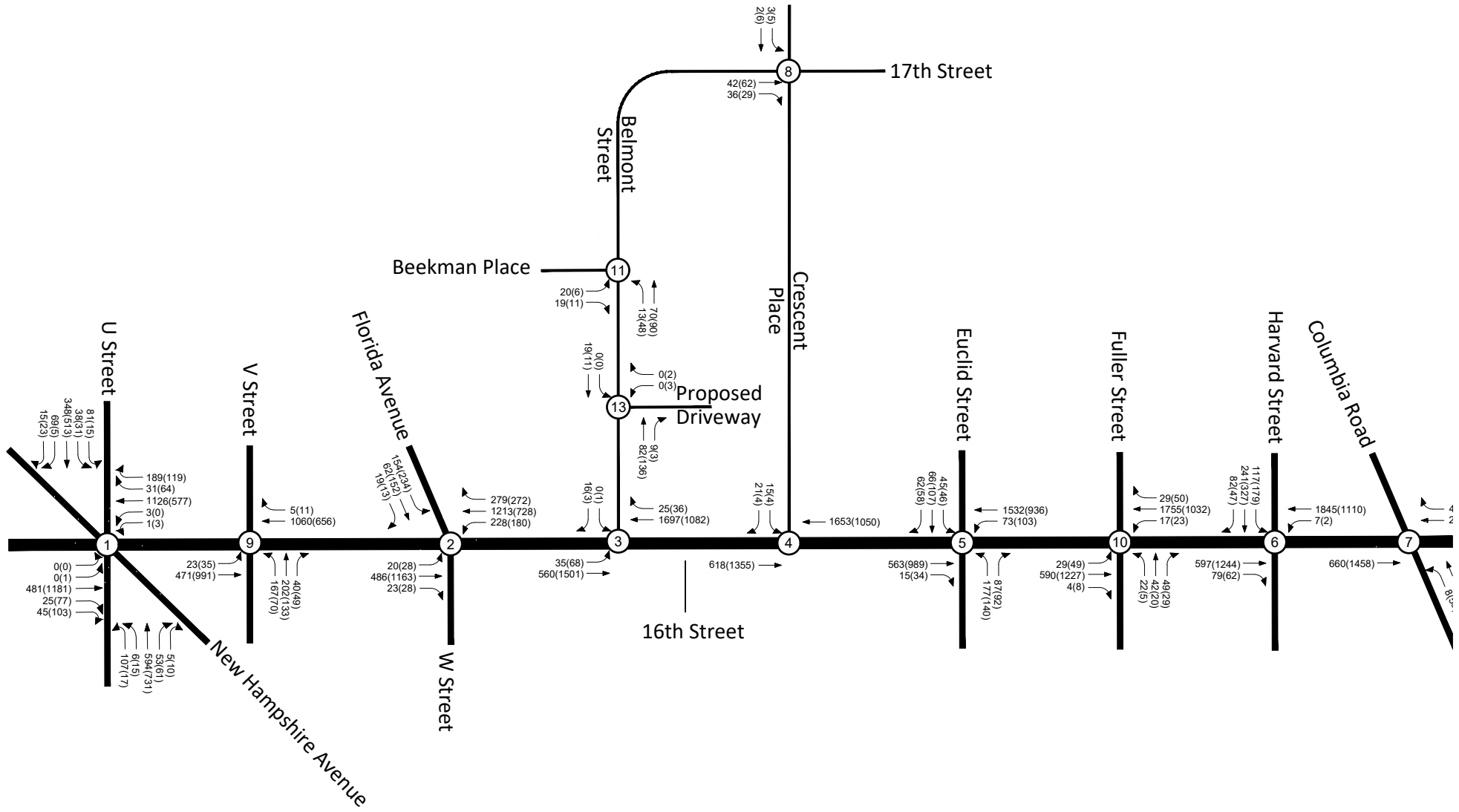

**Figure 15B**  
2022 Background Peak Hour Traffic Volumes with Rerouting

AM PEAK HOUR  
PM PEAK HOUR  
000 (000)



NORTH

2300 16th Street NW  
Washington, DC



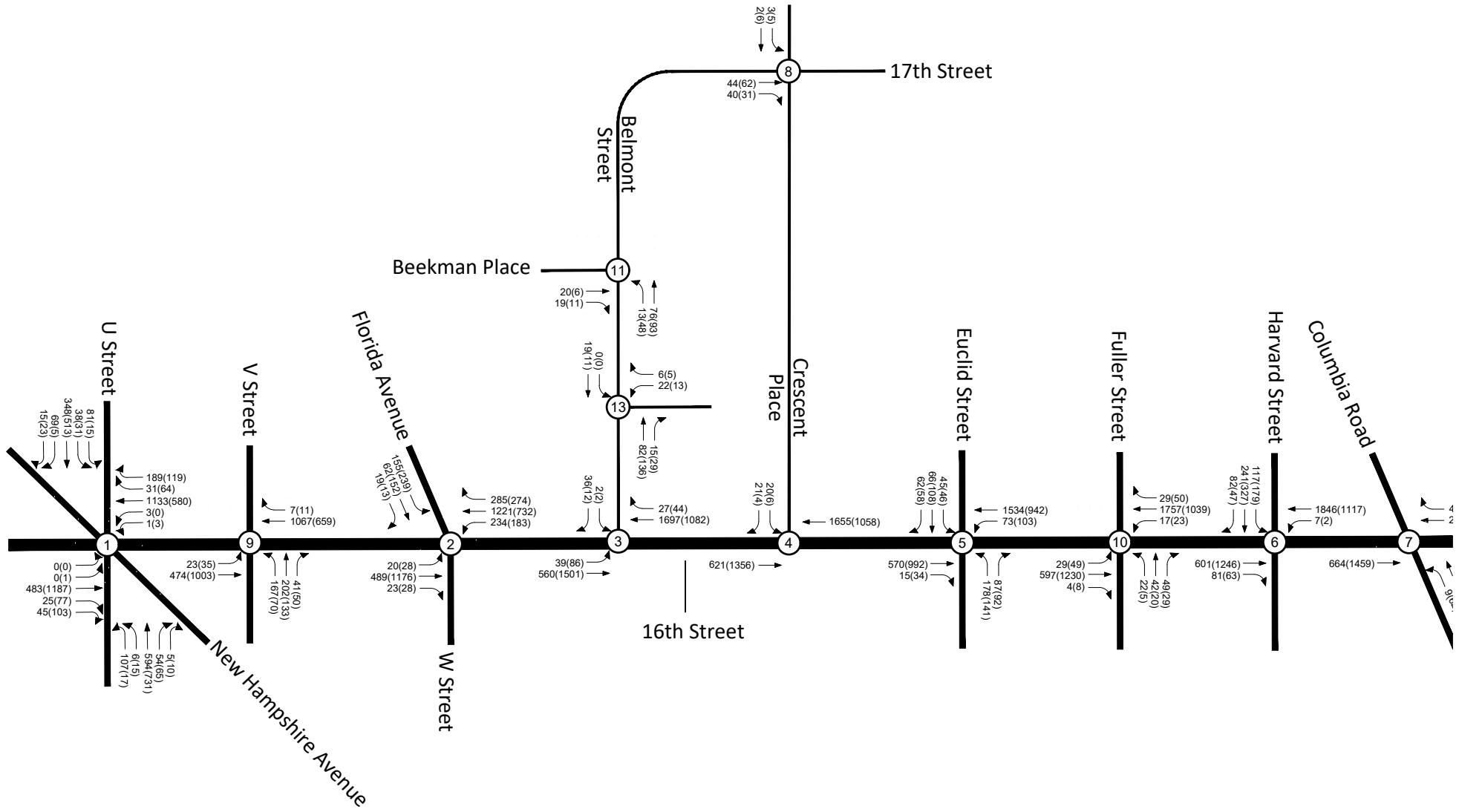

**Figure 16**  
2022 Total Future Peak Hour Traffic Volumes

AM PEAK HOUR  
PM PEAK HOUR  
000 (000)



NORTH

2300 16th Street NW  
Washington, DC



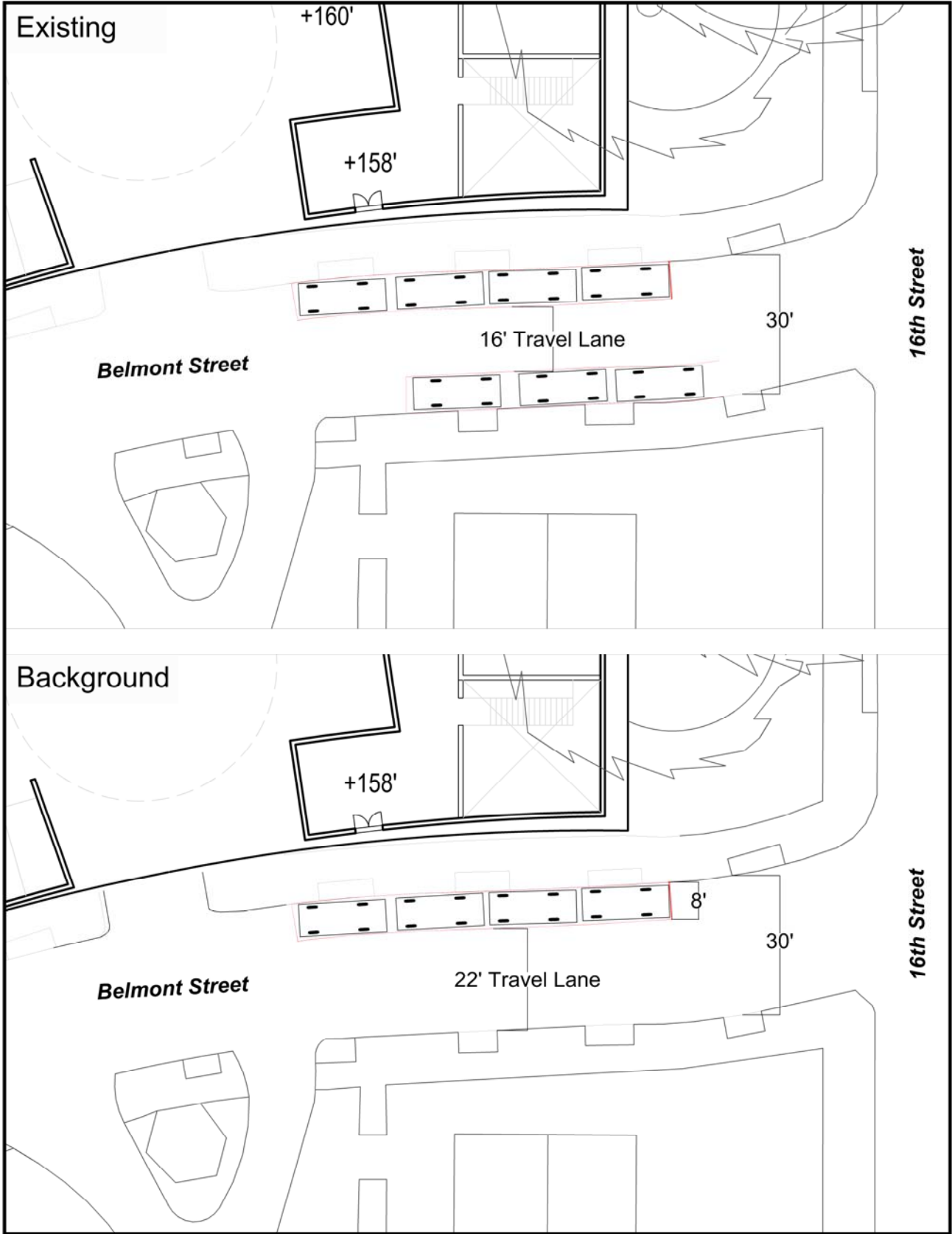

**Figure 17**  
Belmont Street  
Existing and Proposed Conditions



NORTH

2300 16th Street NW  
Washington, D.C.

